

# The Thurland

4 bedroom, 2 storey house

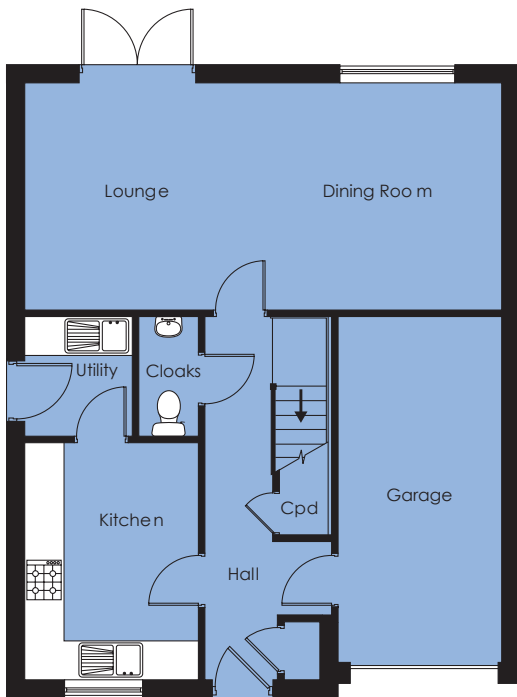

Sales and information centre off Cranfleet Way,  
Long Eaton, Nottinghamshire NG10 3RJ  
Telephone: 0115 946 8363  
Email: sales@westermanhomes.co.uk



## Ground Floor

Lounge/Dining	7.3m x 3.4m	23'11" x 11'1"
Kitchen	2.65m x 3.62m	8'8" x 11'10"
Cloaks	0.91m x 1.82m	3'0" x 5'11"
Garage	2.52m x 5.3m	8'3" x 17'4"

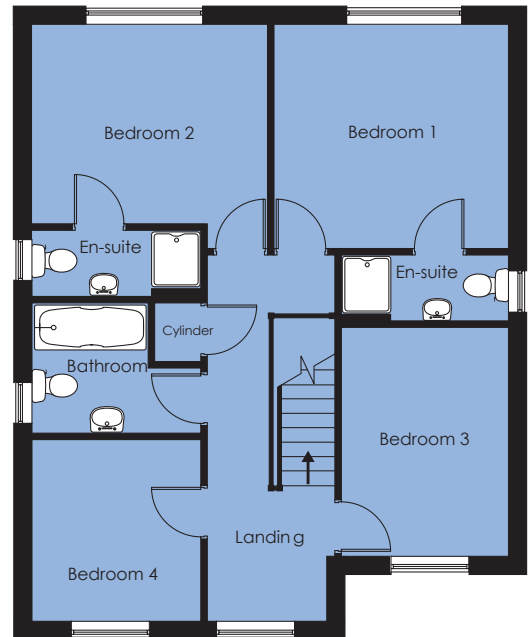

## First Floor

Bedroom 1	3.59m x 3.42m	11'9" x 11'2"
En-suite	2.5m x 1.00m	8'4" x 3'3"
Bedroom 2	3.61m x 3.05m	11'10" x 10'8"
Bedroom 3	2.5m x 3.5m	8'2" x 11'5"
Bedroom 4	2.57m x 2.77m	8'5" x 9'1"
Bathroom	2.57m max x 2m	8'5" max x 6'6"